

TYPICAL FLOOR PLAN (1ST TO 4TH FLOOR) BLOCK - 1

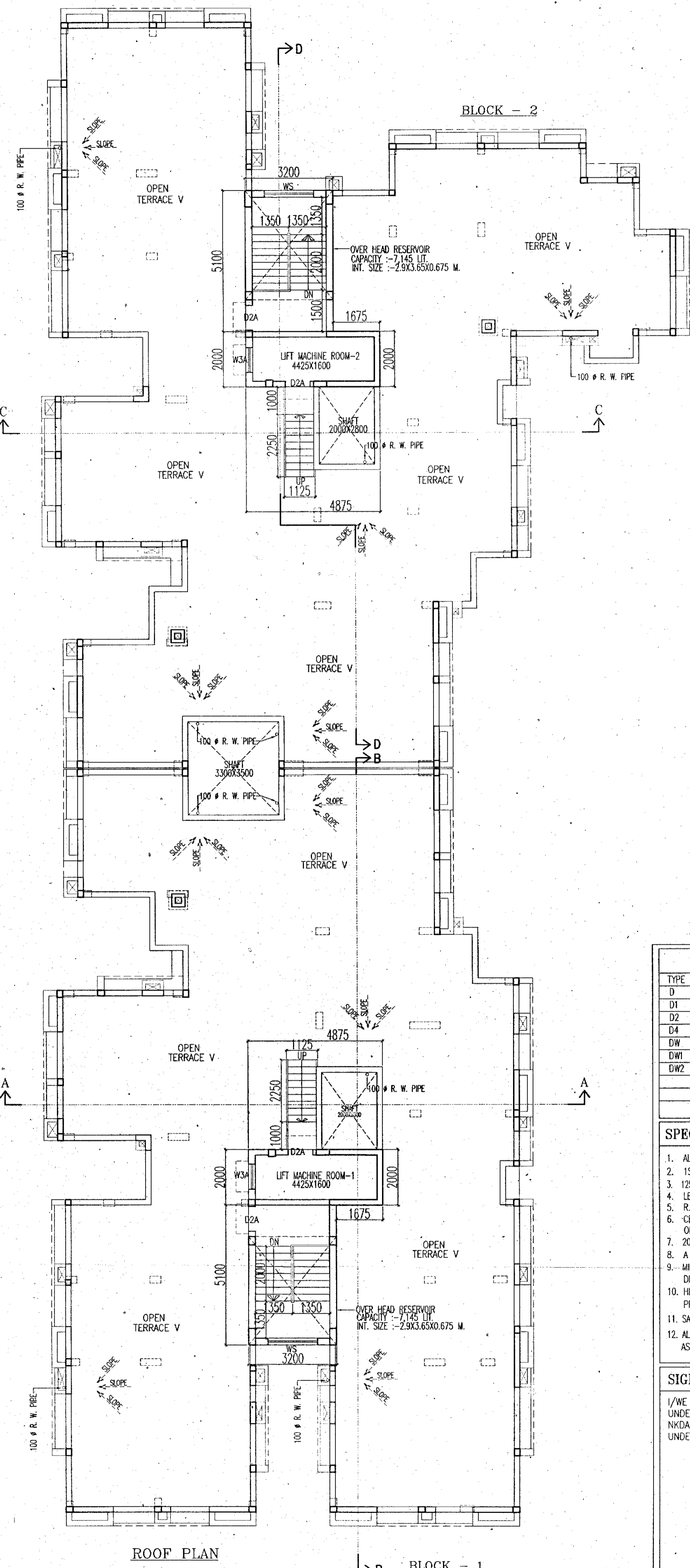

ROOF PLAN BLOCK - 1

SCHEDULE OF DOORS & WINDOWS

TYPE	SILL	LINTEL	SIZE	TYPE	SILL	LINTEL	SIZE
D	-	2100	1500X2100	W1	275	2100	1500X1825
D1	-	2100	1100X2100	W2	275	2100	1200X1825
D2	-	2100	900X2100	W3	275	2100	900X1825
D4	-	2100	750X2100	W4	900	2100	900X1200
DW	-	2100	1800X2100	WS	900	2100	1800X1200
DW1	-	2100	1500X2100	WK	1050	2100	900X1050
DW2	-	2100	1425X2100	WK1	1050	2100	750X1050
				V1	1200	2100	600X900
				V2	1200	2100	350X900

- SPECIFICATION OF BUILDING**
1. ALL DIMENSIONS ARE IN MM.
 2. 1ST CLASS CEMENT BRICK WORK IN SUPER STRUCTURE.
 3. 125X75 MM THK 1ST CLASS BRICK WORK 1:4 WITH H.B. WIRE NETTING.
 4. LEAN CONC. 1:3:6 WITH 16 MM. DOWN GRADED STONCHIPS.
 5. R.C.C. WORK FOR ROOF, SLAB, LINTEL, BEAM, COLUMN(M-15).
 6. CEMENT SAND PLASTER 19 MM. THK. ON OUTSIDE & INSIDE WALLS ON 12 MM. & 6 MM. THK. IN CEILING & R.C.C. CHAJJA.
 7. 20 MM. THK. I.P.S. FLOORING WITH NEAT CEMENT AT TOP INCL. SKIRTING.
 8. A BRICK FLAT SOLING IN FLOORING & FOUNDATION.
 9. MILD STEEL T-BARS FOR COLUMNS, BEAMS, LINTELS & SLABS INCLUDING DISTRIBUTORS & BINDERS.
 10. HIRE & LABOUR FOR SHUTTERING OF R.C.C. WORKS INCLUDING STOUT PROP. TO BE PLACED AS PER DIRECTION.
 11. SANITARY & PLUMBING, FITTING & FIXING COMPLETE AS PER DIRECTION.
 12. ALL OUTSIDE WALLS 250 MM. THK. & INSIDE WALL 125 & 75 MM. THK. AS STATED WITH H.B. WIRE NETTING IN EVERY 3RD LAYER.

SIGNATURE OF OWNER

I/WE CONFIRM THAT THE ERECTION OF BUILDING TO BE UNDERTAKE SHALL BE STRICTLY IN ACCORDANCE WITH THE NKDA PLANNING AREA ACT 2014 AND THE RULES MADE THERE UNDER.

MAGNOLIA INFRASTRUCTURE DEVELOPMENT LTD.
Director
VIVEK ROYDAR
(CONSTITUTED ATTORNEY)

NAME OF OWNER

CERTIFICATE OF ARCHITECT

I CERTIFY THAT ALL THE ARCHITECTURAL DRAWINGS OF THE PROJECT AT J.L. NO.-28, DAG NOS.-701(P), 701/860 KHATIAN NOS.-3037, MOUZA - BHATENDA, UNDER RAJARHAT - BISHNUPUR NO - 1 GRAM PANCHAYET RAJARHAT, DIST.- NORTH 24 PARGANAS, HAVE BEEN PREPARED BY ME COMPLYING WITH THE NEW TOWN KOLKATA PLANNING AREA (BUILDING) RULES, 2014. I ALSO CERTIFY THAT THE PLANS AND DRAWINGS PREPARED BY ME COMPLYING WITH ALL THE PROVISIONS REGARDING THE FIRE PROTECTION AS PER THE PREVAILING NATIONAL BUILDING CODE OF INDIA. I SHALL BE HELD RESPONSIBLE IF ANY INCORRECT INFORMATION IS FOUND IN ANY OF THE DRAWINGS AND DOCUMENTS, SIGNED BY ME AND SUBMITTED TO THE SANCTIONING AUTHORITY FOR OBTAINING SANCTION.

Rajkumar Agarwal
Architect
Member of Council of
Architecture CA / 94 / 17940

SIGN. OF ARCHITECT

IT IS HEREBY CERTIFIED THAT THE STRUCTURAL DRAWINGS ARE PREPARED FOR EARTHQUAKE RESISTANCE IN ACCORDANCE WITH BIS & NBC 2005.

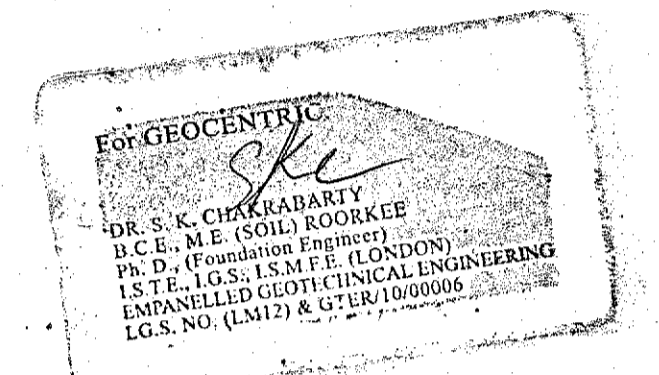

SIGN. OF GEO-TECHNICAL ENGINEER

CERTIFICATE OF STRUCTURAL ENGINEER

CERTIFIED THAT, THE STRUCTURAL DRAWING & DESIGN OF BOTH FOUNDATION & SUPER STRUCTURE OF THE BUILDING / BUILDINGS HAS BEEN MADE CONSIDERING THE SOIL TEST REPORT, AS PER THE RULES AND REGULATIONS MADE UNDER THE ACT AND ALSO CONSIDERING ALL POSSIBLE LOADS, SEISMIC LOAD AND THE MOMENTS GENERATED BY THE PROPOSED STRUCTURE AS PER THE BUREAU OF INDIAN STANDARDS AND NATIONAL BUILDING CODE OF INDIA AND CERTIFIED THAT IT IS SAFE & STABLE IN ALL RESPECT AND THESE PROVISIONS SHALL BE ADHERED TO DURING THE CONSTRUCTION.

Mainak Majumdar
B.C.E., M.C.E. (Struct)
ESE-152/11 of GMC
STER/RAJKA/10/00020
074/RJPSON/ESE/11-12

SIGN. OF STRUCTURAL ENGINEER

TITLE

TYPICAL FLOOR PLAN (1ST TO 4TH FLOOR) & ROOF PLAN.

PROJECT

COMPLETION PLAN OF G+IV STORED (14.95 MT. HT.) RESIDENTIAL BUILDING AT J.L. NO. - 28, DAG NOS. - 701(P), 701/860 KHATIAN NOS. - 3037, MOUZA - BHATENDA, UNDER RAJARHAT - BISHNUPUR NO - 1 GRAM PANCHAYET RAJARHAT, DIST.- NORTH 24 PARGANAS.

DATE	JOB. NO.	DEALT	CHECKED	SHEET NO.
18.11.2020	ARCH/631/2017	SOMNATH		03 OF 05

SCALE
1: 100
ARCHITECT
RAJ AGARWAL & ASSOCIATES
8B, ROYD STREET, KOLKATA-16

FOR OFFICE USE ONLY

Executive Officer
Rajarhat Panchayat Sanity